

E-Series

WATER HEATER EQUIPPED WITH A MAGNESIUM ANODE AND AN IMMERSION DIRECT HEATING ELEMENT



+ PRODUCT

QUALITY - DURABILITY

- Magnesium anode for strengthened tank protection
- Diamond-quality enamel (glass-lined inner tank)
- Pressure relief valve
- Dielectric union
- Specific lip gasket to avoid corrosion around flange
- Rod type thermostat (regulation + manual reset safety cut-out)

USER-FRIENDLINESS

- IP 24 full compliance with European standards for electrical safety and user protection
- External thermometer
- Heating light indicator

SAVINGS

- Mechanical thermostat with integrated security
- High-efficiency water inlet
- CFC-free high-density insulation for more energy savings

ELECTRIC WATER HEATER

30 TO 100 L
(HORIZONTAL WALL-MOUNTED)



Model available*

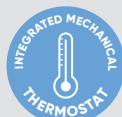

Temperature regulation



More hot water

MAGNESIUM
ANODE

Tank protection

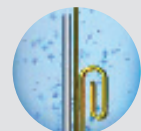

Copper heating element

* Model types: A: Vertical wall-mounted / B: Horizontal wall-mounted / C: Floor-standing

E-series



- 1 Diamond-quality enamel (glass-lined inner tank)
- 2 Optimised stainless steel outlet pipe
- 3 Magnesium anode
- 4 Inlet diffuser
- 5 CFC-free high density insulation foam
- 6 Sheathed immersion heating element
- 7 Thermostat with manual reset safety cut-out
- 8 Heating light indicator
- 9 External thermometer
- 10 Bracket for wall-mounting

INSTALLATION DIMENSIONS

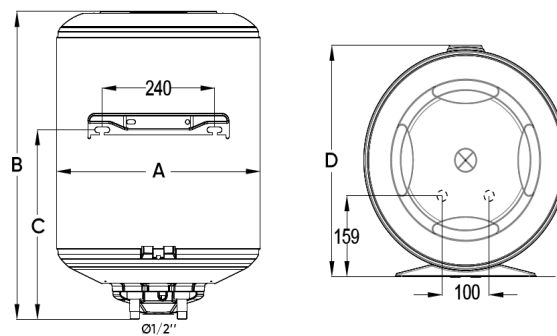

TECHNICAL DATA

CAPACITY (L)	OUTPUT (W)	VOLTAGE (V)	HEAT-UP TIME AT 60°C (ΔT=50°C)	ENERGY CONSUMPTION (KWH/24H AT 65°C)
E-Series Vertical wall-mounted				
30	1200	230 (220-240)	1h30	0.80
50	1500	230 (220-240)	2h00	0.88
80	1500	230 (220-240)	3h14	1.32
100	1500	230 (220-240)	4h02	1.62

DIMENSIONS

CAPACITY (L)	DIMENSIONS (mm)				FLANGE OPENING (Ø) mm	NET WEIGHT (kg)
	A	B	C	D		
E-Series Vertical wall-mounted						
30	433	427	244	451	72	14
50	433	581	373	451	72	16
80	433	821	586	451	72	20
100	433	1000	740	451	72	22

IP 24