



This certifies that

AQUATEKNIK (FZE)

has had the undermentioned product examined, tested and found, when correctly installed, to comply with the requirements of the United Kingdom Water Supply (Water Fittings) Regulations and Scottish Water Byelaws.

RHINO 7.F226S SERVICING VALVE

The certificate by itself is not evidence of a valid WRAS Approval. Confirmation of the current status of an approval must be obtained from the WRAS Directory (www.wras.co.uk/directory)

The product so mentioned will be valid until the end of:

July 2019

1487967

Certificate No.

Secretary

Chairman, Product Assessment Group

The Water Regulations Advisory Scheme Ltd. Registered in England No. 3022224 Registered office: 11 Hensley Place, Hensley Grove, Stockport, Cheshire, SK7 3BA
Tel: +44(0)161 257 9028 Fax: +44(0)161 257 940 Email: info@wras.co.uk Website: www.wras.co.uk



BRASS PLUMBERS WARE

**HIGH STANDARD OF QUALITY
AND DURABILITY!**

**BRASS
ANGLE
VALVES**

**BRASS
BALL
BIB TAPS**

**BRASS
BALL
VALVES**

**BRASS
PLUMBERS
WARE**

www.rhinovalves.com

www.rhinovalves.com

ANGLE VALVE

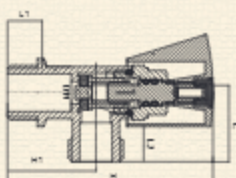
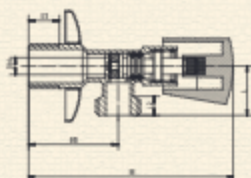

Forged Brass Body with Chrome Plating
Normal Pressure : 16Bar
With S.S. 304 Grade rosette

Product code	Size	L	L1	L2	H	H1	DN
RH7102012	1/2" X 1/2"	23.25	14.5	9	96.5	42.25	8
RH7102235	1/2" X 3/8"	23.25	16	9	91	39	8

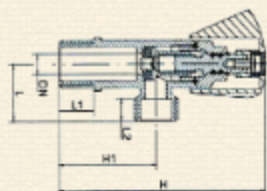

Forged Brass Body with Chrome Plating
Normal Pressure : 16Bar
With S.S. 304 Grade rosette
With spare Indice

Product code	Size	L	L1	L2	H	H1	DN
RH7101612	1/2" X 1/2"	24.75	17.00	10.00	85	39.50	8.50

Forged Brass Body with Chrome Plating
Normal Pressure : 16Bar
With Spare Indice



Product code	Size	L	L1	L2	H	H1	DN
RH77226512	1/2" X 1/2"	26.5	11.5	9	79	34	8.5

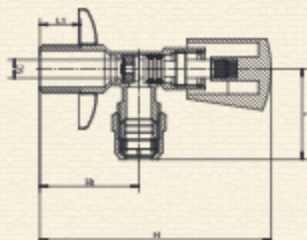

Forged Brass Body with Chrome Plating
Normal Pressure : 16Bar
With S.S. 304 Grade rosette
With M10 Conical Nut
With Spare Indice

Product code	Size	L	L1	H	H1	DN
RH7102135	1/2" X 3/8"	39.5	16	91	39	8

BRASS BALL VALVE

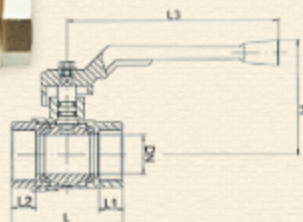
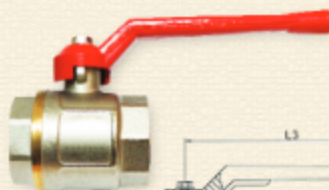

Forged Brass Body
Forged Aluminum Handle
Working Pressure PN10

Product code	Size	L	L1	L2	L3	H	DN
RHMBV12	1/2"	48.50	12.00	12.00	95.00	45.00	10.00
RHMBV24	3/4"	55.00	12.00	12.00	95.00	52.00	15.00
RHMBV100	1"	63.00	13.00	13.00	107.00	55.00	24.00
RHMBV114	1 1/4"	77.00	14.50	14.50	120.00	71.25	32.00
RHMBV112	1 1/2"	83.00	16.00	16.00	137.00	75.00	37.00
RHMBV200	2"	99.00	19.00	19.00	157.00	81.00	45.00
RHMBV300	3"	146.00	26.00	26.00	243.00	122.55	71.00
RHMBV400	4"	172.40	26.50	26.50	243.00	148.00	92.00

BRASS PUMP OUTLET EXTENSION

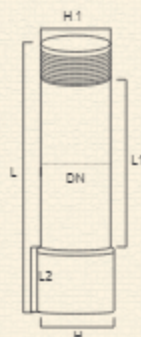

Forged Brass Body

Product code	Size	L	L1	L2	H	H1
RH1001PH100	1"	100	84	24	35	30

BALL BIB TAP / HOSE COCK

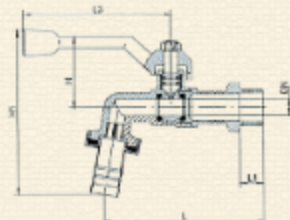
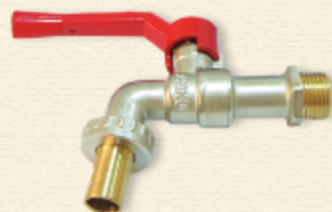

Forged Brass Body
Aluminum Handle
Working Pressure PN10

Product code	Size	L	L1	L2	H	H1	DN
RHMBKT1512	1/2"	85	11	78	48	98	10
RHMBKT2024	3/4"	95	12	78	48	101	12
RHMBKT25100	1"	115	15	100	57	110	15